

Foundation Plants are often 5 gallon in size at time of installation - but can also be effective with 1 gallon plants.

All foundation plants in a row
 At maturity, plant should align with edge of architecture - but do not go beyond.

Evenly Spaced Plants
 Balanced on Architecture
 Same Species

Evenly Spaced Plants
 Balanced on Architecture
 Same Species

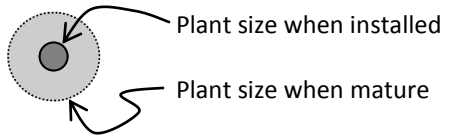

Foundation Planting - The purpose of Foundation Planting is to establish a “base” for the house with an even row of plantings. Many foundation planting become hedged and formal. Foundation Plants typically grow to a height of 18” to 36”.

For 5' side yard - 1 plant min
 For 10' side yard - 2 plants min
 For >10' side yard - 48" o.c. max

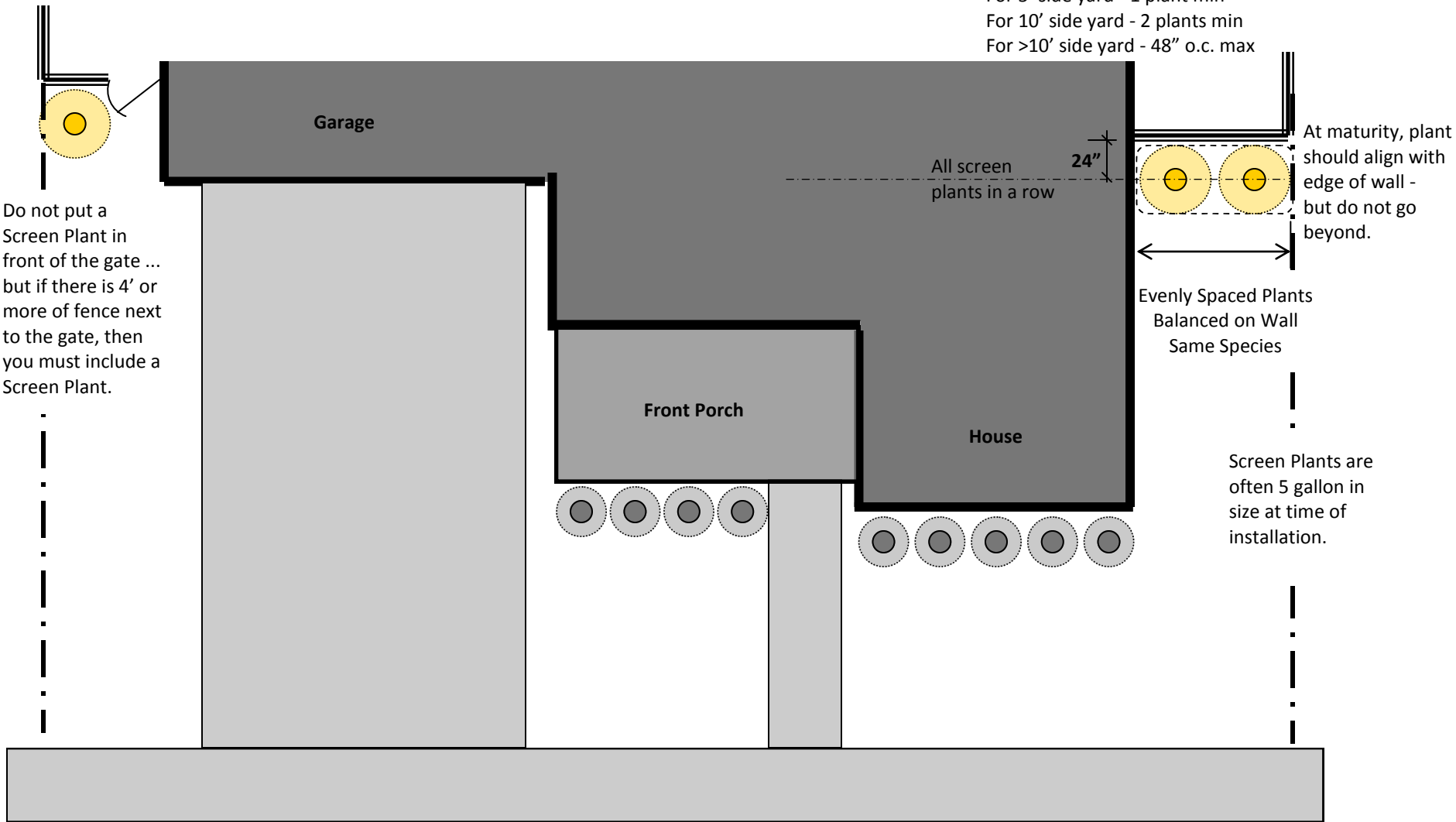

Do not put a Screen Plant in front of the gate ... but if there is 4' or more of fence next to the gate, then you must include a Screen Plant.

All screen plants in a row

24"

At maturity, plant should align with edge of wall - but do not go beyond.

Evenly Spaced Plants
 Balanced on Wall
 Same Species

Screen Plants are often 5 gallon in size at time of installation.

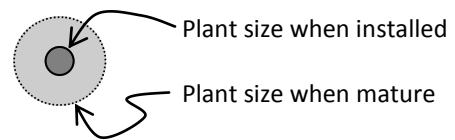

Screen Planting - The purpose of Screen Planting is to hide fences and large unarticulated walls. Foundation plants usually grow to a height of about 5' to 6'.

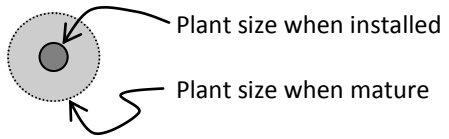
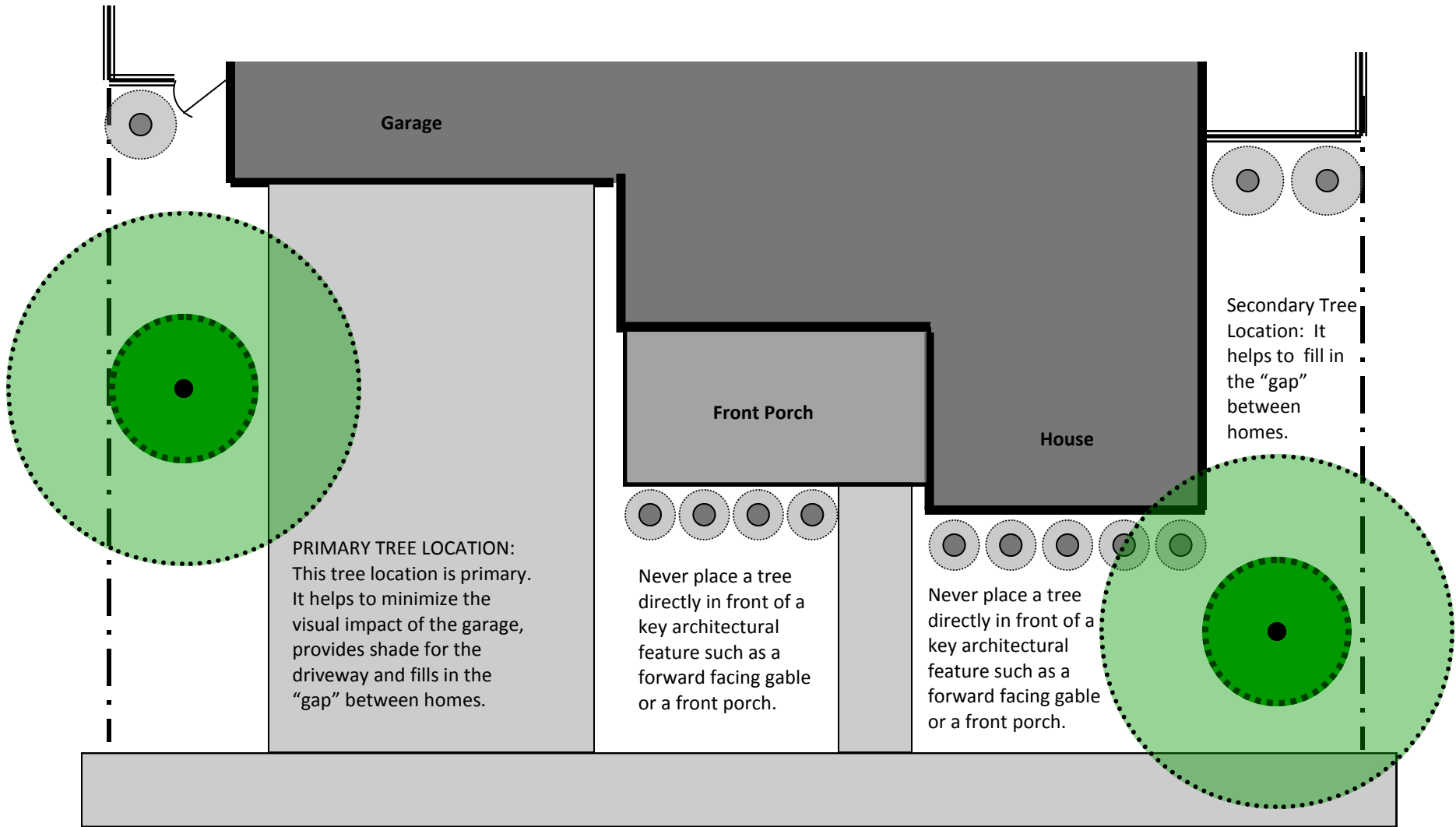

Trees
 For lots 55' wide or less - 1 front yard tree is required
 For lots 55' to 100' wide - 2 front yard trees are required
 For lots over 100' wide - 3 front yard trees are required

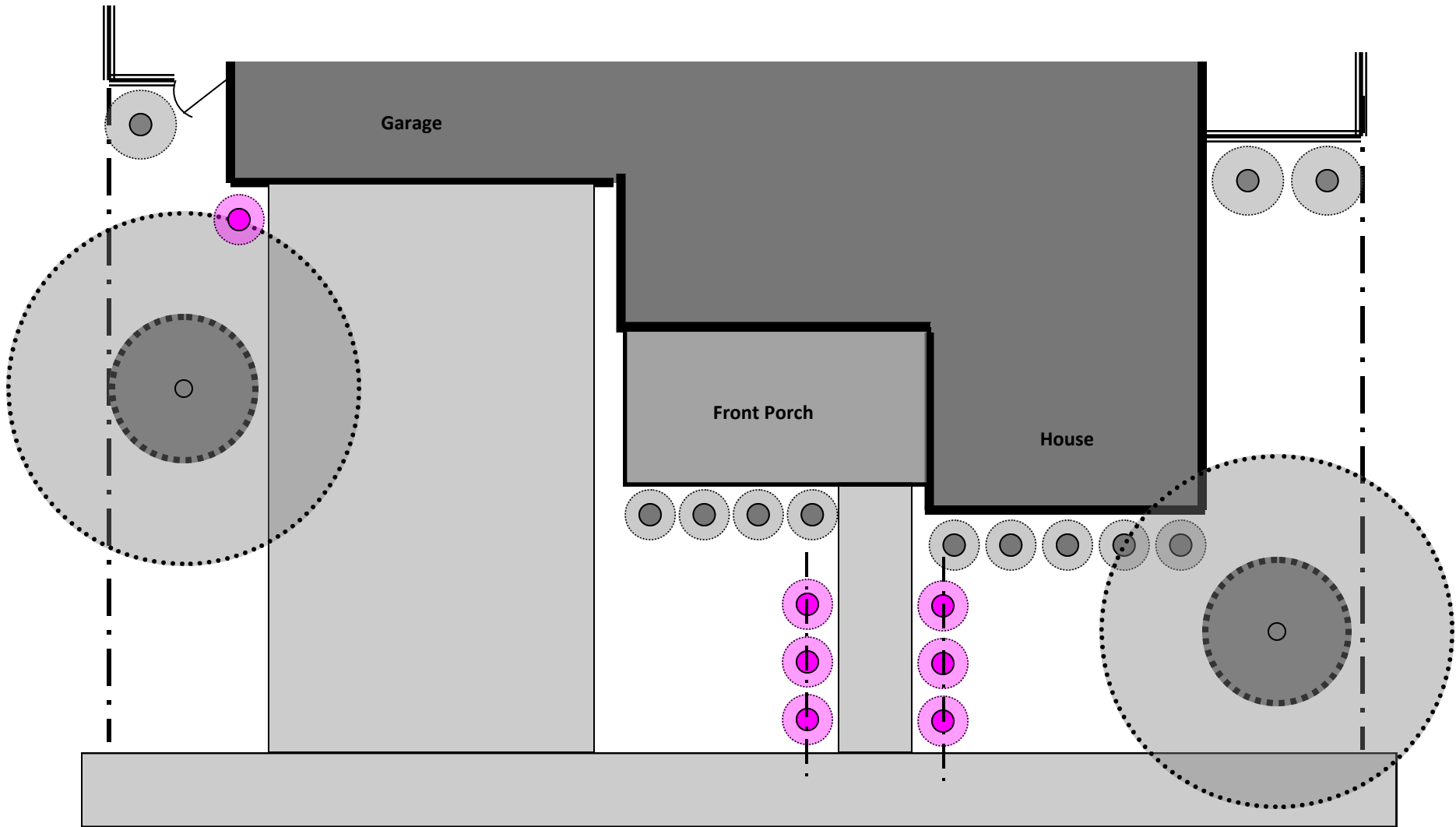

Accent Planting - Accent plants tend to be more unique and come in a wide range of sizes and shapes. Accent plants are typically used on either side of a walkway, steps, entrance or door. Accent plants can be individual plants, or they can be small groupings.

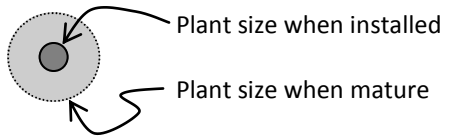
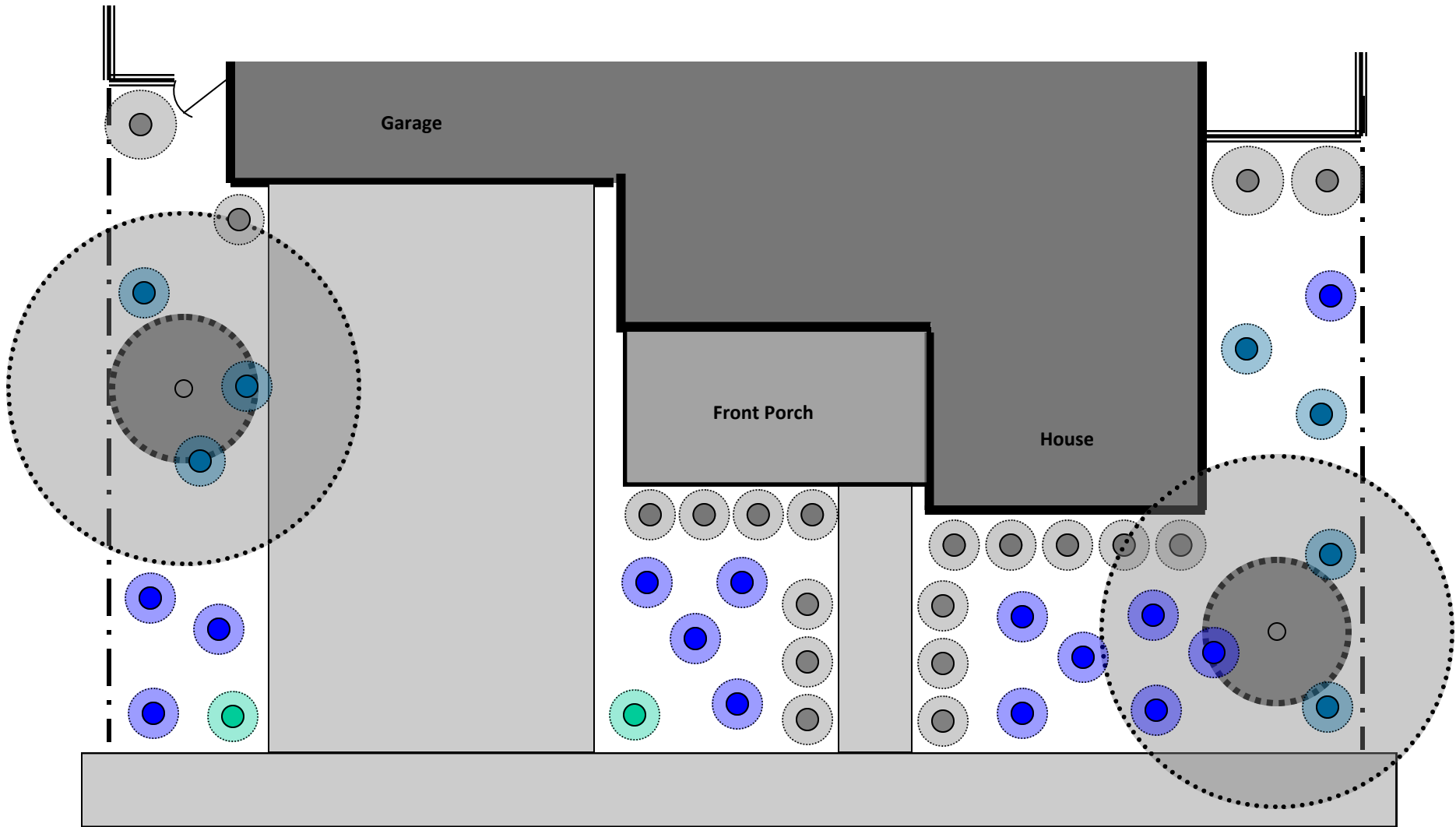

Field Planting / Mass Planting - Turf is the most common Field Planting. But other small plants can also be used as Field Plants. **Field Plants tend to be lower in scale with a mature height of about 8" to 16"**. The patterns tend to be triangulated or slightly random. In general, do not "line up" field planting. Field Planting can consist of more than one species ... when multiple species are used, they are usually placed in clusters, drifts or groupings.

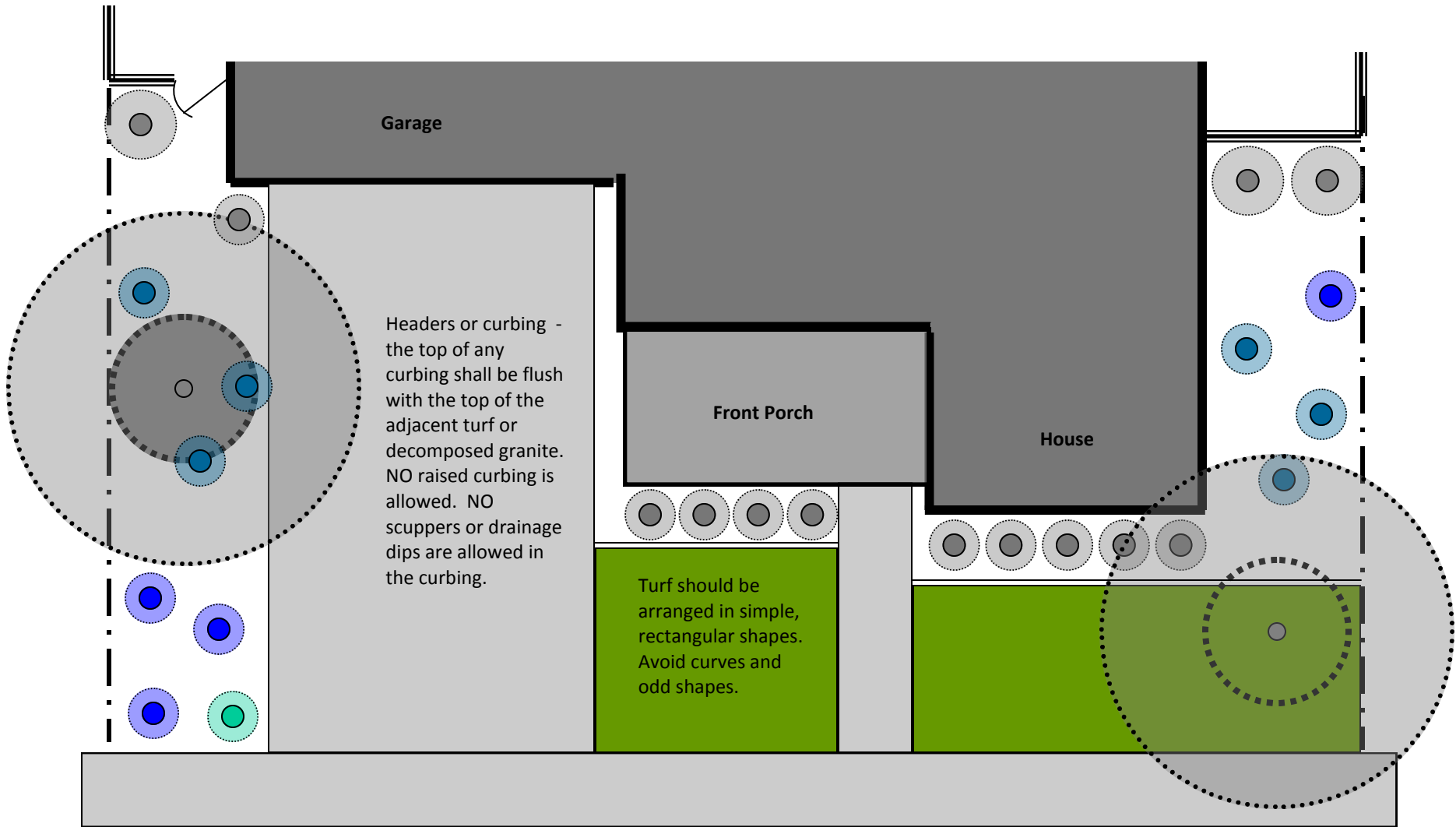

Headers or curbing - the top of any curbing shall be flush with the top of the adjacent turf or decomposed granite. NO raised curbing is allowed. NO scuppers or drainage dips are allowed in the curbing.

Turf should be arranged in simple, rectangular shapes. Avoid curves and odd shapes.

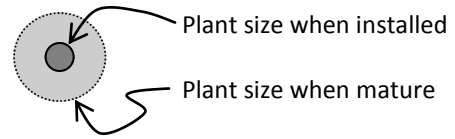

Turf must extend to the public sidewalk and to the driveway.
Turf may not look like a "putting green" or an "island".

Field Planting / Turf - Turf is the most common Field Planting.